

New Build
 Re-furbish

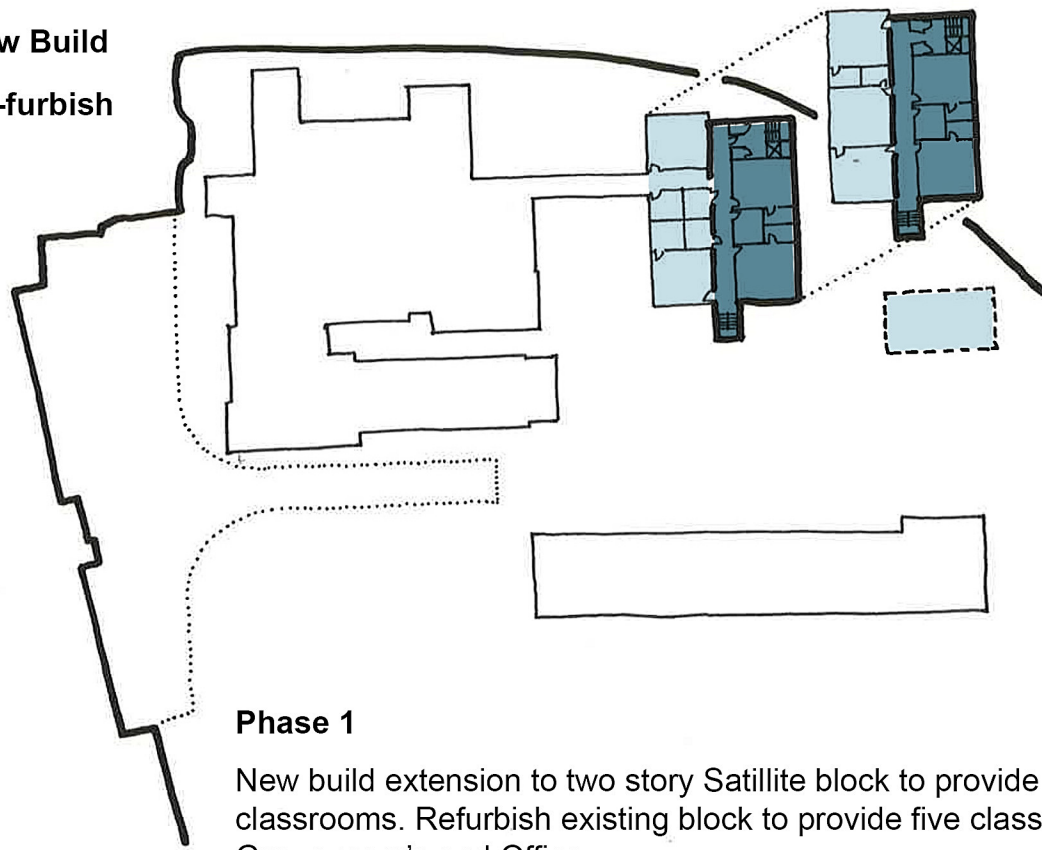

Phase 1

New build extension to two story Satillite block to provide four additional classrooms. Refurbish existing block to provide five classrooms, Wc's, Group room's and Office.

Relocate double temporary classrooms from Cliffdale

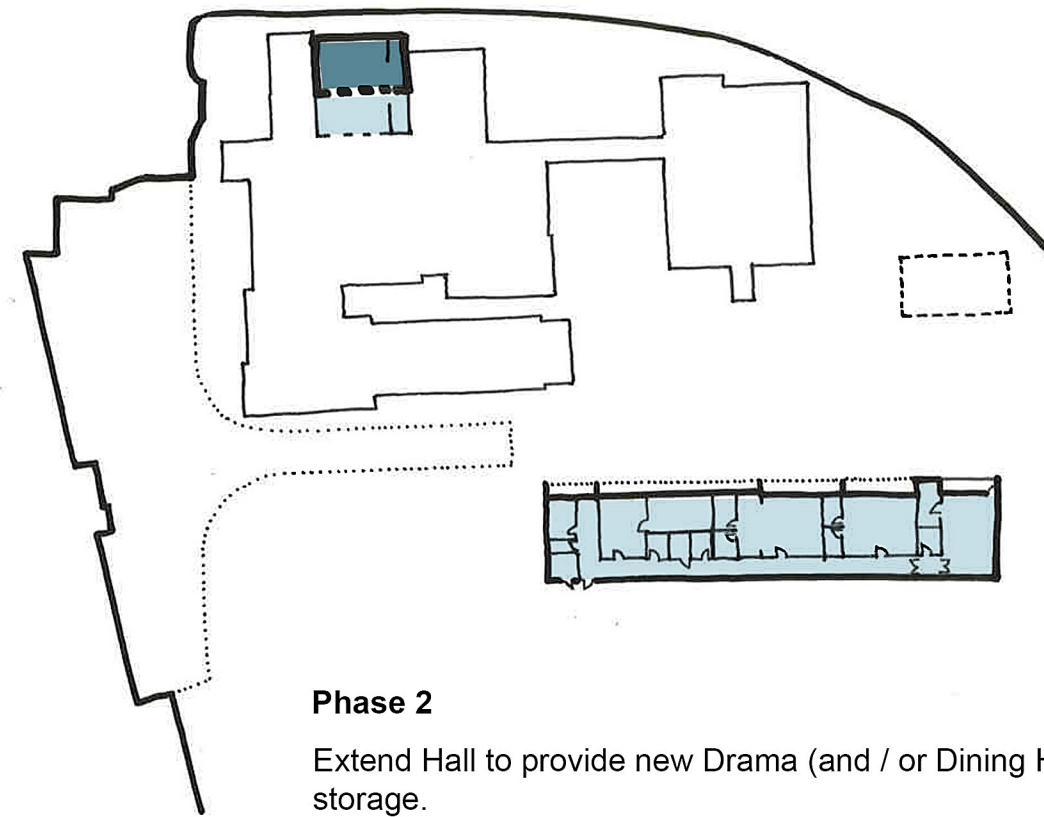

Phase 2

Extend Hall to provide new Drama (and / or Dining Hall) and additional storage.

Refurbish single story satellite block to provide specialist spaces (Retain temporary classrooms)

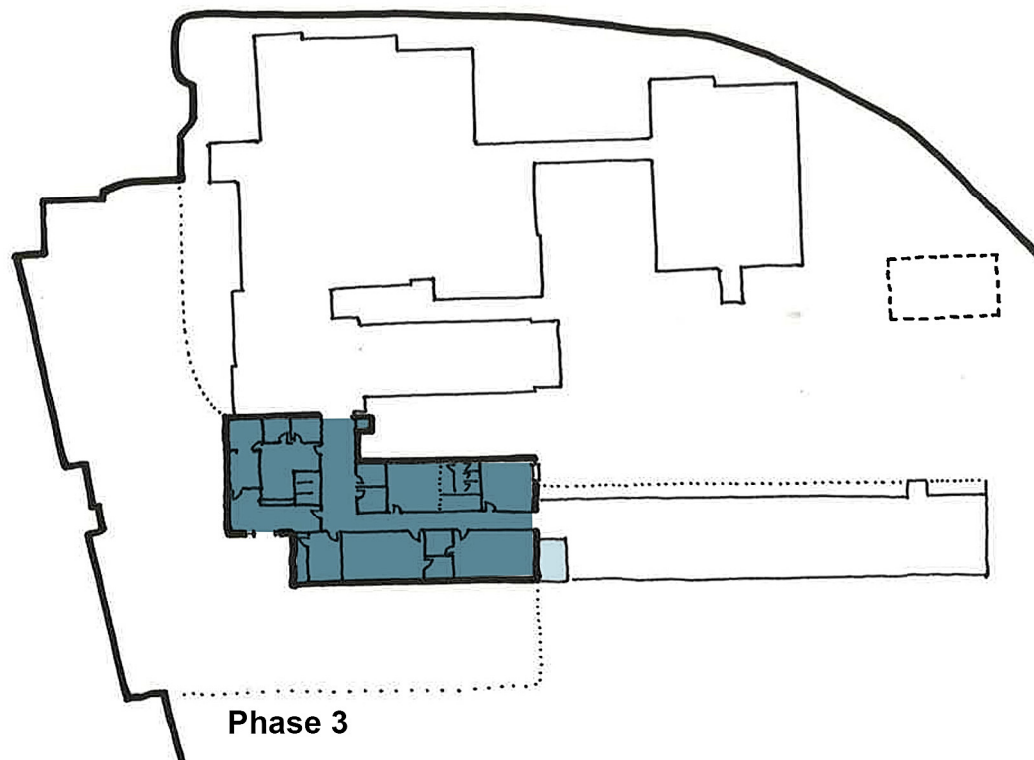

Phase 3

New build Entrance, Administration Management and Specialist Teaching extension. Link to satellite block. Relocate Car Park. (Note lift to extension to two story building)

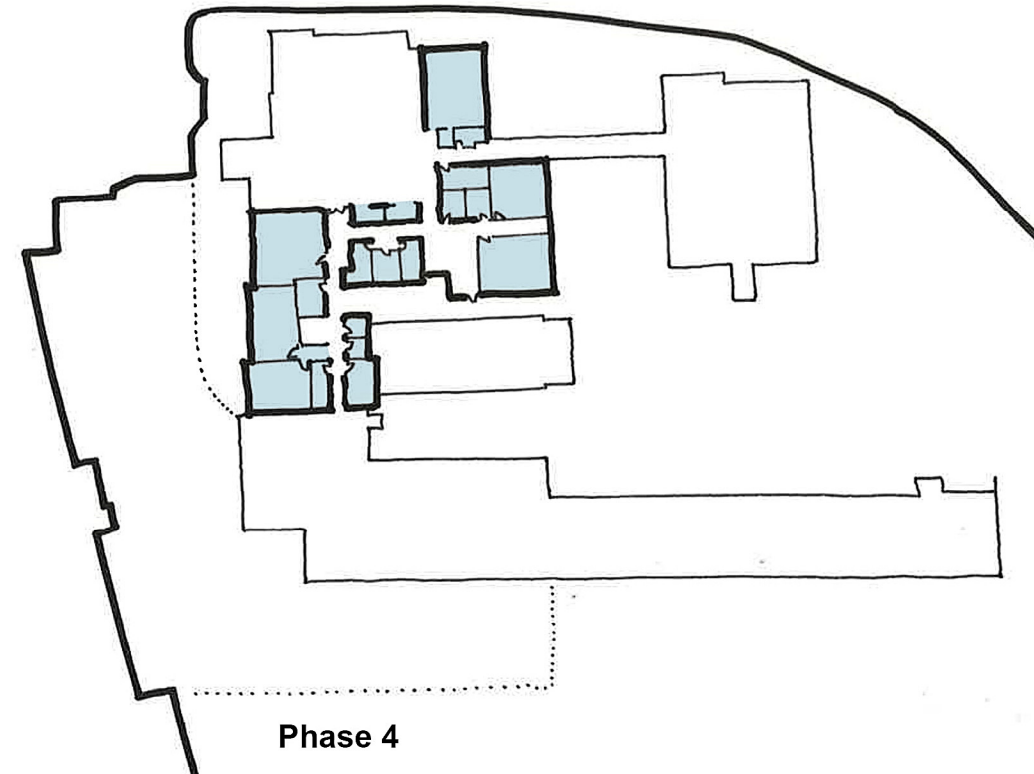

Phase 4

Internal refurbishment to ground floor and first floor existing building to preserve teaching spaces (Class Bases). Suited with group rooms, Re suite Wc's.

Resolve internalcirculation. Remove temporary classrooms (As required)